

Pressure gauge DN 63 vertical connection with glycerin (1/4" BSP)

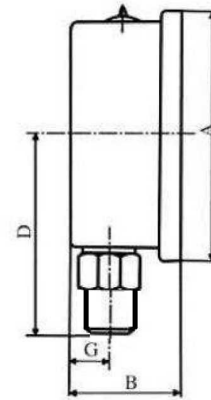
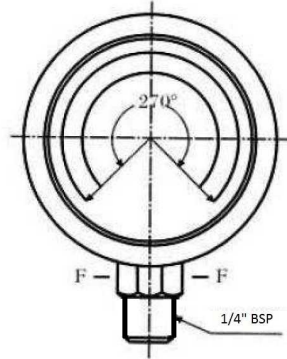

Accuracy: 1,6%

Dimensions: A=68
B=29,8
D=54,5
F=HEX 14
G=9,5

Temperature: from -20 up to +60

Material: Case: stainless steel 304
Ring: stainless steel 304
Window: polycarbonate (glass)
Socket & Connection: brass

Scale: Bar / Psi IP65

Part n°	R1	Scale (bar)
MFI6304001V	1/4" BSP	0-1
MFI63042.5V	1/4" BSP	0-2.5
MFI6304004V	1/4" BSP	0-4
MFI6304006V	1/4" BSP	0-6
MFI6304010V	1/4" BSP	0-10
MFI6304012V	1/4" BSP	0-12
MFI6304016V	1/4" BSP	0-16
MFI6304020V	1/4" BSP	0-20
MFI6304025V	1/4" BSP	0-25
MFI6304040V	1/4" BSP	0-40
MFI6304060V	1/4" BSP	0-60
MFI6304100V	1/4" BSP	0-100
MFI6304160V	1/4" BSP	0-160
MFI6304250V	1/4" BSP	0-250
MFI6304315V	1/4" BSP	0-315
MFI6304400V	1/4" BSP	0-400

The information gathered in this technical documentation (Catalogue) has an informative character and can be modified without previous notice. DICSQ will not accept any type of responsibility resulting from an inappropriate use of the product, except the ones related to manufacturing defects.

Pressure gauge DN 63 vertical connection with glycerin (1/4" BSP)

2/2

Part n°	R1	Scale (bar)
MFI6304600V	1/4" BSP	0-600
MFI63041000V	1/4" BSP	0-1000

***** Review attached PDF*****With dual bar/psi scale
IP65